



DNS MRI CENTER

1001 ROBBIE MINCE WAY
DESOTO, TX 75115

Patient Name _____

Cell# _____ Home# _____ Work# _____

SS# _____ Insurance _____ D.O.B. _____

Diagnosis / Symptoms _____

Please call Patient to Schedule

Please Pre-cert

Fax Report to:

STAT Call Report to:

CONTRAST: YES - NO - AT RADIOLOGIST DISCRETION

(Please Circle) **SEDATION:** YES - NO

MRI			MRA
Neuro:	Spine:	Shoulder	Brain Cartoid
Brain	Cervical	Knee	
Orbits	Thoracic	Hip	
Pituitary	Lumbar		
IACs	Brachial Plexus		
Physician's Name & Phone#			Physician's Signature & Date

PHONE: 214-622-6306 • FAX: 214-622-6307



DNS MRI CENTER

1001 ROBBIE MINCE WAY

DESOTO, TX 75115

GENERAL INSTRUCTIONS

This appointment time has been reserved just for you. If you are unable to keep your appointment, Please notify us as soon as possible. Please arrive 15 minutes early for your appointment in order to complete necessary paperwork. Please also bring your insurance cards and any related prior MRI or CT scans you have available. If you have your prior exams with you, then the radiologist will be able to accurately compare the studies and look for any change between the examinations.

MRI Information

MRI examination uses a strong magnet to take images of your body. If you have any metal objects in your body, you may not be able to have an MRI examination. If you have any of the following implanted devices, you will not be able to have an MRI. These include:

- Pacemaker
- Aneurysm Clip
- Metal in eyes
- Ear Implants
- Spinal Cord Stimulators

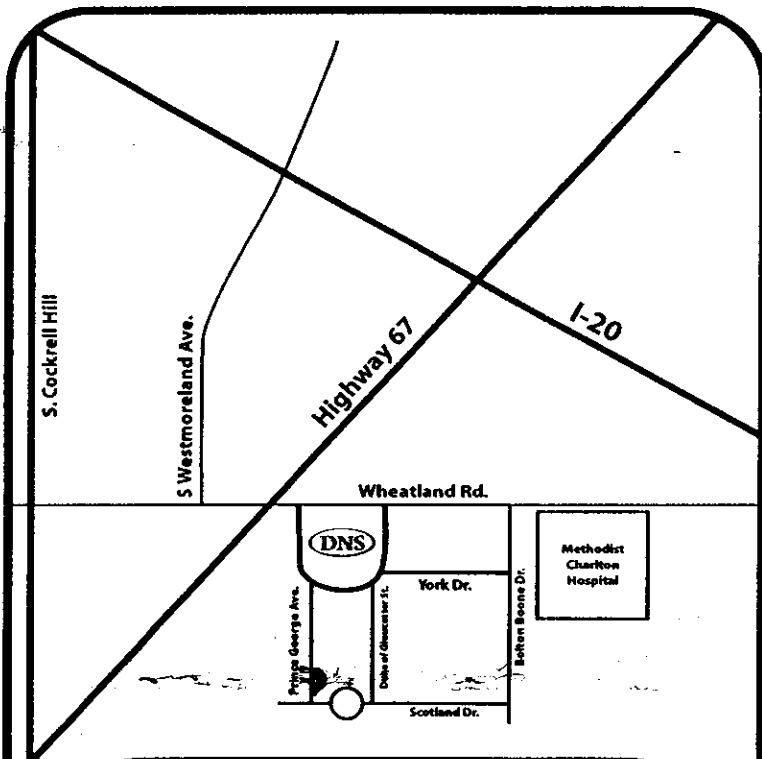

Directions to the Test Center:

On Highway 67, exit on Wheatland turn east on Wheatland when you see the Credit Union make a right turn, the Center is located just south of the Credit Union on Wheatland.

BUN / Creatinine Information

Recent Creatinine laboratory value required for IV contrast if patient has the following history:

- Renal Disease
- Heart Disease
- Diabetes
- Meds that affect kidneys

A MRI Coordinator will call you with the next few days to schedule for the test. In the event that you did not receive a call, you may call them directly to schedule the test.

DNS MRI Center Phones:

214-622-6306

214-622-6305